

FOR DESIGN PURPOSES ONLY  
 NOT TO BE USED FOR  
 CONSTRUCTION

CONTROL: GENERAL INFORMATION				
CONTROL SET BY:				
CONTROL SET DATE MM/YYYY:	05/2024			
HORIZONTAL DATUM:	CANADA/NAD83-ORIG (ONTARIO)/UTM ZONE 17, MAP PROJECTION: CSRS to NAD83-ORIG (ONTARIO)/UTM ZONE 17, GRID SHIFT: ONB3CSM4.gdb			
VERTICAL DATUM:	CGVD2878			
COORDINATES (GRID/GROUND):	GRID			
SCALE FACTOR:	0.9997			
ROH FIELD BOOK/S:	Canadian_h2_0.grd			
REGION FILE PATH:	891			
CONTROL STATION REPORT				
POINT ID.	NORTHING	EASTING	ELEVATION	DESCRIPTION
3477BMA	483224.509	576869.024	361.691	TOP OF SOUTHERN DAYLIGHTING SIB AT SOUTHWEST CORNER OF COMMERCE CRES. INTERSECTION
347701	483225.086	576884.217	361.517	RIB SET IN GRAVEL SHOULDER ON EAST SIDE OF COMMERCE CRES. (NORTH/SOUTH) WHERE COMMERCE CRES. INTERSECTS WITH ITSELF (EAST/WEST)
347702	4832107.176	576890.885	363.531	RIB SET IN GRASS BOULEVARD AT NORTHWEST CORNER OF COMMERCE CRES. AND WALLACE ST. INTERSECTION
347703	4832400.724	576845.443	361.812	RIB SET IN GRAVEL SHOULDER ON NORTHEAST SIDE OF COMMERCE CRES. BETWEEN ENTRANCES FOR CIVIC ADDRESSES #20 & 24
347704	483275.577	576786.207	362.279	RIB SET IN GRAVEL SHOULDER ON WEST SIDE OF COMMERCE CRES. 48M SOUTH OF SOUTHERN ENTRANCE FOR CIVIC ADDRESS #29
347705	4832544.213	576765.109	362.483	RIB SET IN GRAVEL SHOULDER ON NORTHEAST SIDE OF COMMERCE CRES. 46M SOUTHEAST OF DRIVEWAY FOR MUNICIPAL ADDRESS #36
347706	4832616.814	576670.175	363.145	RIB SET IN GRAVEL SHOULDER ON NORTH SIDE OF COMMERCE CRES. 11M WEST OF ENTRANCE FOR CIVIL ADDRESS #40
347707	4832515.064	576598.319	363.706	RIB SET IN GRAVEL SHOULDER ON SOUTHWEST SIDE OF COMMERCE CRES. BETWEEN THE TWO ENTRANCES FOR CIVIC ADDRESS #49
347708	4832411.772	576527.930	366.615	RIB SET IN GRAVEL SHOULDER ON WEST SIDE OF COMMERCE CRES. ON CORNER, 45M SOUTHWEST OF SOUTHWESTERN ENTRANCE FOR CIVIL ADDRESS #60
347709	4832331.432	576617.492	362.365	RIB SET IN GRAVEL SHOULDER ON NORTHEAST SIDE OF COMMERCE CRES. BETWEEN ENTRANCES FOR CIVIC ADDRESSES #49 AND 61
347710	483230.916	576721.008	361.197	RIB SET IN GRAVEL SHOULDER ON SOUTH SIDE OF COMMERCE CRES 40M WEST OF ENTRANCE FOR CIVIC ADDRESS #70

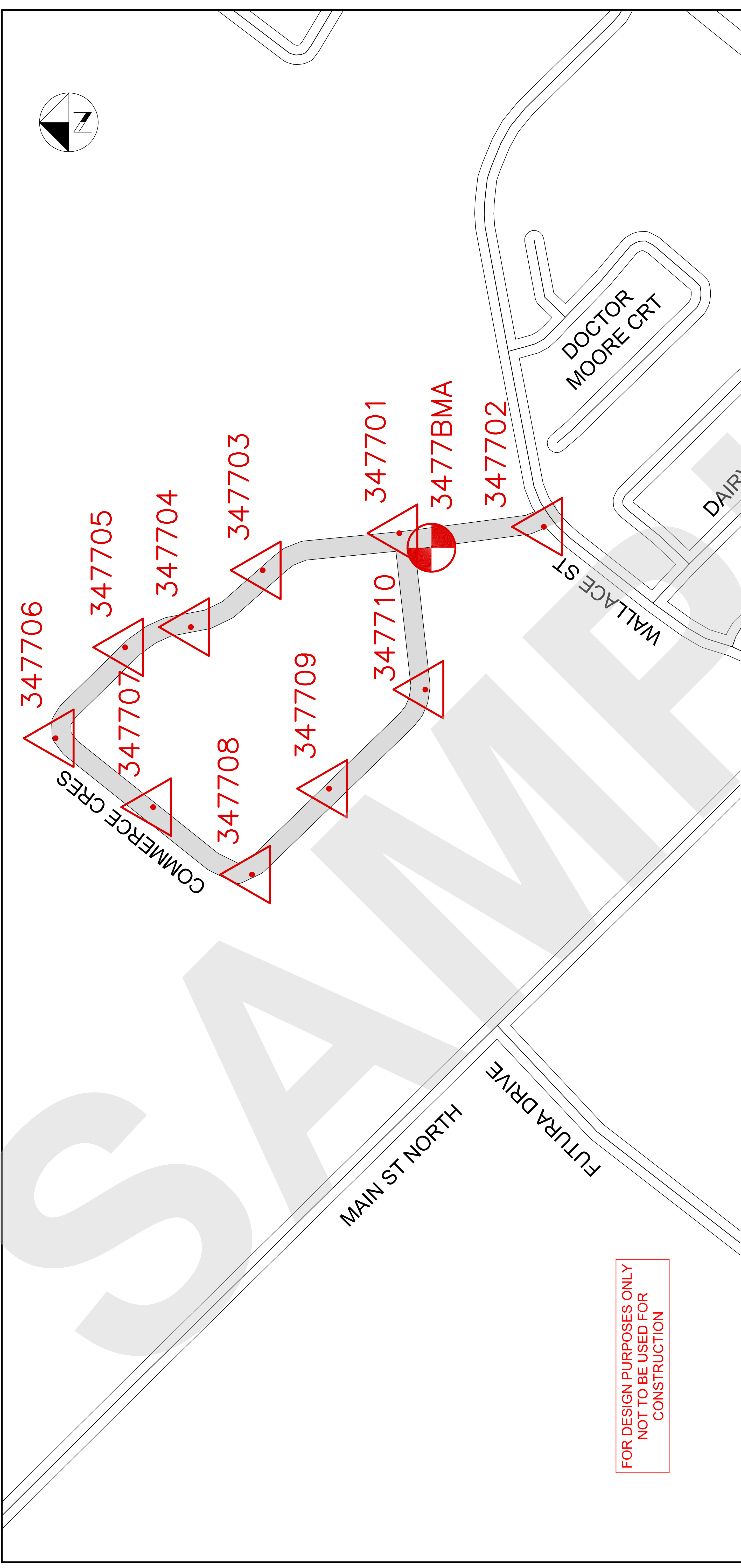



**Halton**  
REGION

CONTROL STATION REPORT COMMERCE CRESCENT PROPOSED W/M & W/M FROM WALLACE ST TO END TOWN OF ACTON	
CONSULTANT FILE NO.	REGIONAL DRAWING NO.
CONTRACT NO. <b>WS-3477-24</b>	DRAWING NO. CSR 1 OF 1
SCALE N.T.S.	DATE: MAY 21, 2024
DESIGN NO. DATE BY	REVISIONS
DRAWN DH	CH/KD DSL